

Welcome - Community Survey Regarding Westview Park

The City of Elliot Lake is exploring options for improving Westview Park and would love your input! Your feedback will help guide decisions about new structures, amenities, and enhancements. Thank you for sharing your thoughts.

How often do you visit Westview Park? *

- Daily
- Weekly
- Monthly
- Rarely
- I haven't visited

What activities do you typically enjoy at Westview Park? (Check all that apply) *

- Attending the Summer Concert Series
- Renting or attending events (e.g., weddings)
- Using the Children's play area
- Walking/hiking the nature trail
- Relaxing/picnicking
- Other

If you selected other please specify: *

What type of structure would you like to see replace the old pavilion? (Please note, these are example photos of structure shapes. Final product/finishes may differ slightly).

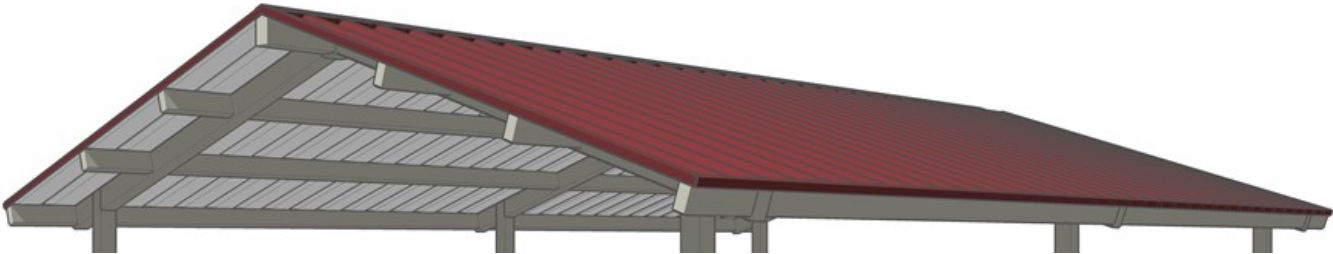

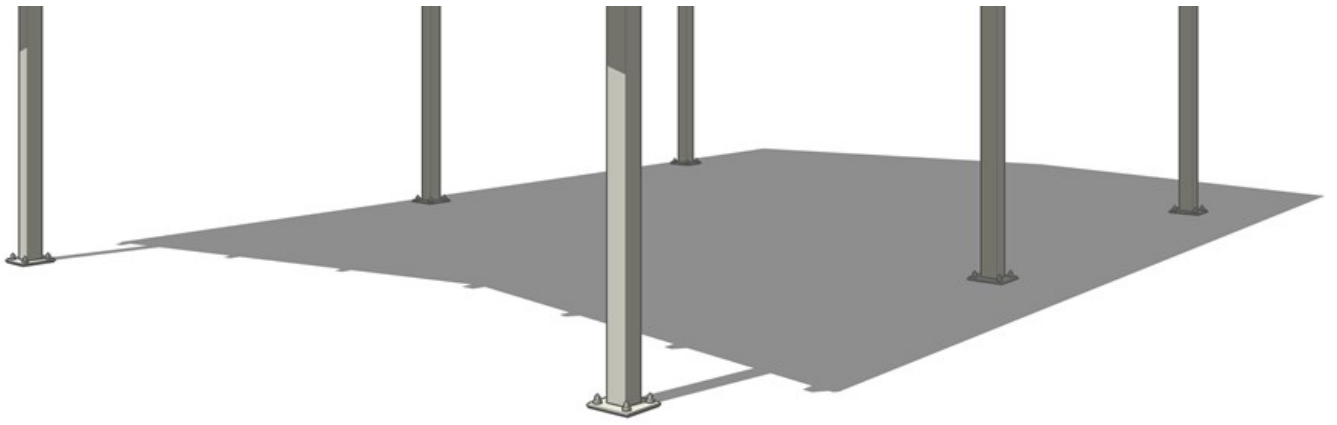

Option 1



Option 2

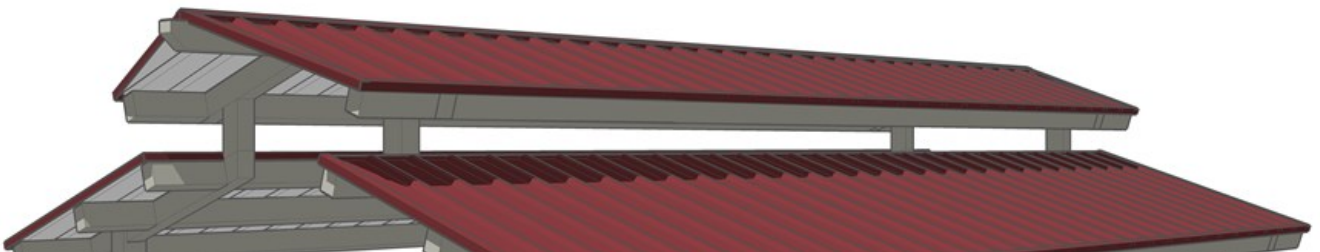

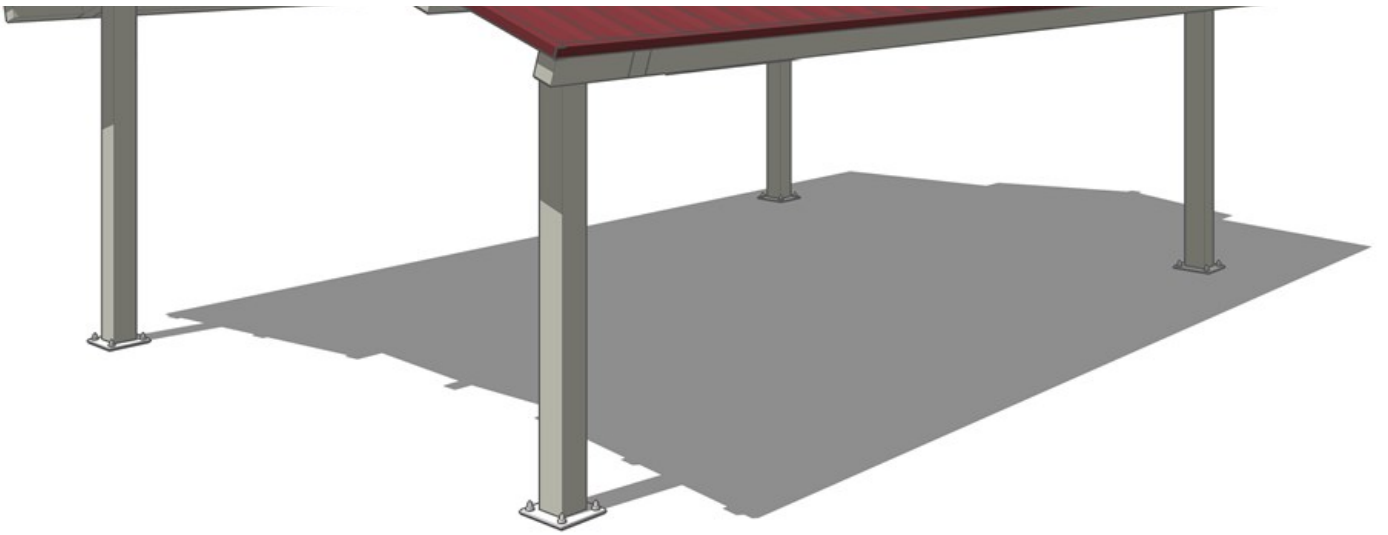

Option 3

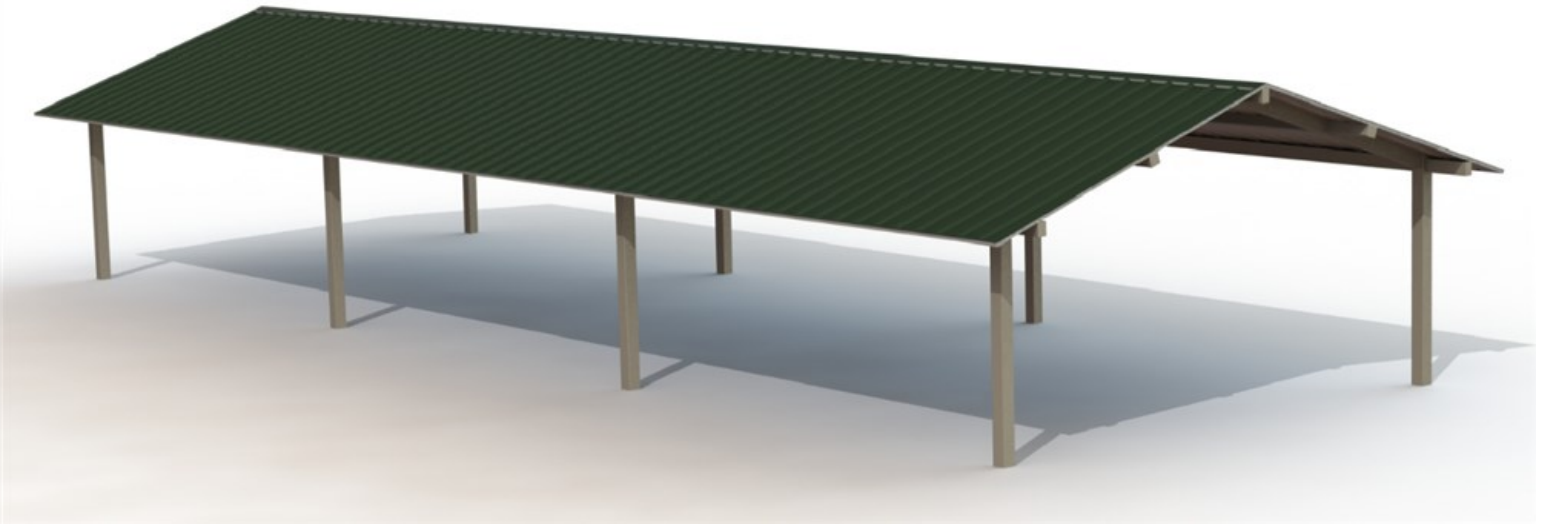

Option 4





Option 5

Please state which option (out of the 5 photo options) you like best:

- Option 1
- Option 2
- Option 3
- Option 4
- Option 5

What additional amenities or features would improve your experience at Westview Park?

- More seating areas
- Improved playground equipment
- Enhanced trail signage or maps
- Public art installation
- Better lighting for safety
- A designated area for community events or small gatherings
- Other

Other (please specify): *

Are there any specific accessibility improvements you'd like to see in the park?

- Yes
- No Suggestions

Yes (Please specify): *

How important is maintaining the natural character of Westview Park to you?

- Very important
- Somewhat important
- Not very important

**Do you have any suggestions for improving the summer concert series or making the park more event-friendly?
(please share your thoughts)**

Do you have any other ideas or suggestions for enhancing Westview Park? (please share your thoughts)

Thank You for Completing the Survey.